

### Gramercy | \$629,641

17135 HARDISTY WAY, Bowie, MD 20715 | Homesite 52B

2,503 Sq. Ft. | 3 Beds | 3 Baths | Availability: 07/2024



Mid-Atlantic Builders<sup>SM</sup> Lot 52B

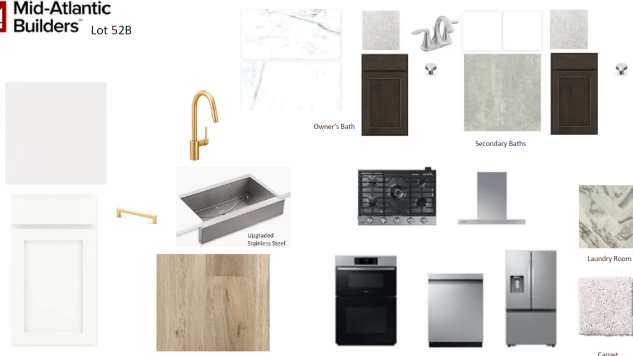

- 20' Wide Townhome with 2-Car Rear Garage
- Entry Level Rec Room and Powder Room with Upgraded Study
- Open-Concept Kitchen Level with Family Room and Dining Area
- Upgraded Sliding Glass Doors off Family Room Leading to Covered Balcony
- Luxurious Primary Suite with Dual Walk-In-Closets and Full Bath
- Two Secondary Bedrooms and Laundry

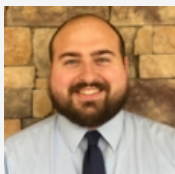

**Matthew Wilson**

 (301) 329-4301

 [mwilson@midatlanticbuilders.com](mailto:mwilson@midatlanticbuilders.com)

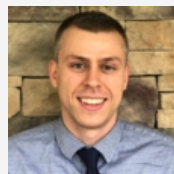

**Leif Wazen**

 (301) 329-4301

 [lwazen@midatlanticbuilders.com](mailto:lwazen@midatlanticbuilders.com)

Programs and incentives subject to change without notice and available only when lender and title company from builders approved list are used. Maximum promotional package value varies by community and houseplan. Builder assistance is not to exceed maximum promotional package value. Not all buyers may qualify for program savings. Qualification to be determined by Mid-Atlantic Builders' preferred lender(s) prior to contract ratification. See a Mid-Atlantic Builders Sales Counselor for specific promotional package details as some restrictions apply. The name Mid-Atlantic Builders and the Mid-Atlantic Builders logo are registered service marks of Mid-Atlantic Builders, Inc. | MHBR #8984



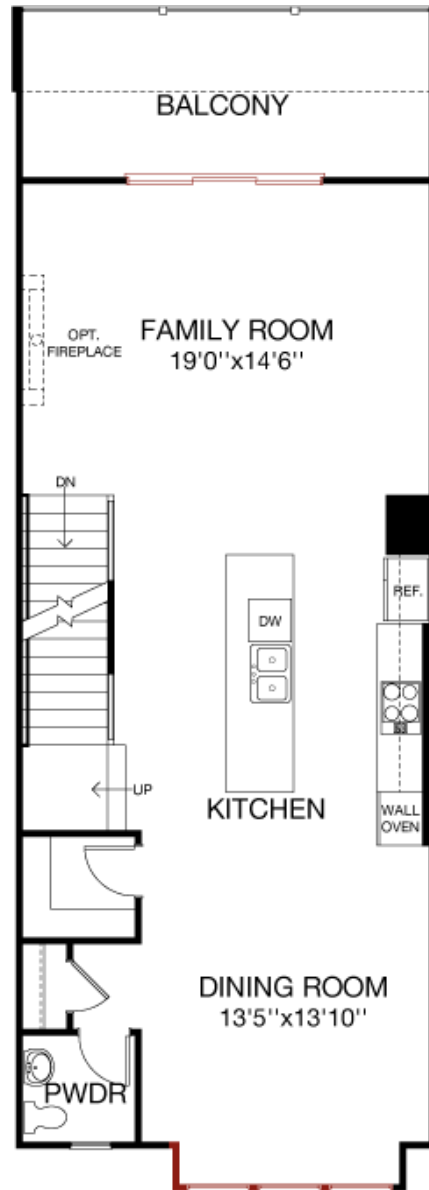

**Floorplan**

**First Floor**



**Matthew Wilson**

 (301) 329-4301

 [mwilson@midatlanticbuilders.com](mailto:mwilson@midatlanticbuilders.com)

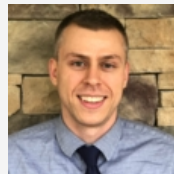

**Leif Wazen**

 (301) 329-4301

 [lwazen@midatlanticbuilders.com](mailto:lwazen@midatlanticbuilders.com)

Programs and incentives subject to change without notice and available only when lender and title company from builders approved list are used. Maximum promotional package value varies by community and houseplan. Builder assistance is not to exceed maximum promotional package value. Not all buyers may qualify for program savings. Qualification to be determined by Mid-Atlantic Builders' preferred lender(s) prior to contract ratification. See a Mid-Atlantic Builders Sales Counselor for specific promotional package details as some restrictions apply. The name Mid-Atlantic Builders and the Mid-Atlantic Builders logo are registered service marks of Mid-Atlantic Builders, Inc. | MHBR #8984



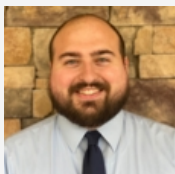
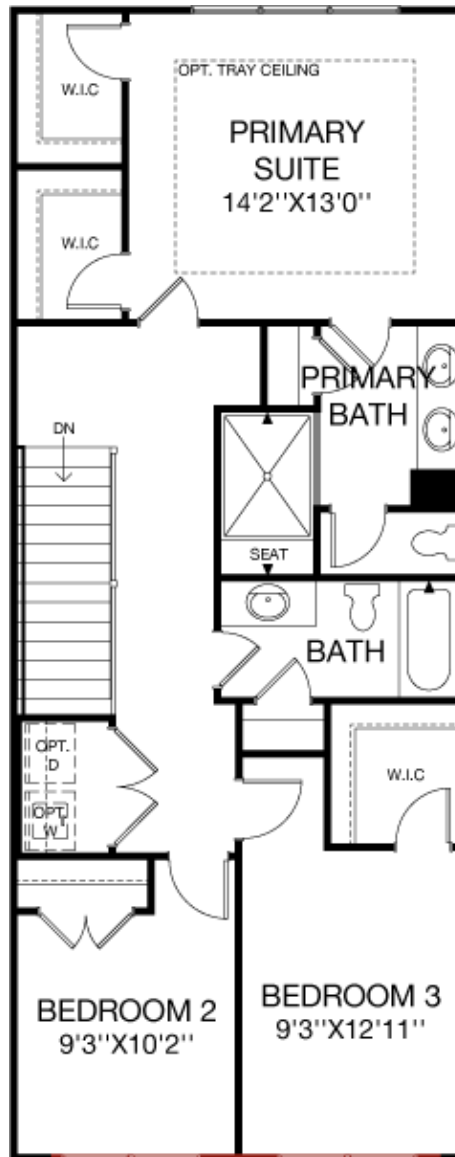

**Floorplan**

**Second Floor**



**Matthew Wilson**

 (301) 329-4301

 [mwilson@midatlanticbuilders.com](mailto:mwilson@midatlanticbuilders.com)

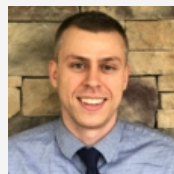

**Leif Wazen**

 (301) 329-4301

 [lwazen@midatlanticbuilders.com](mailto:lwazen@midatlanticbuilders.com)

Programs and incentives subject to change without notice and available only when lender and title company from builders approved list are used. Maximum promotional package value varies by community and houseplan. Builder assistance is not to exceed maximum promotional package value. Not all buyers may qualify for program savings. Qualification to be determined by Mid-Atlantic Builders' preferred lender(s) prior to contract ratification. See a Mid-Atlantic Builders Sales Counselor for specific promotional package details as some restrictions apply. The name Mid-Atlantic Builders and the Mid-Atlantic Builders logo are registered service marks of Mid-Atlantic Builders, Inc. | MHBR #8984



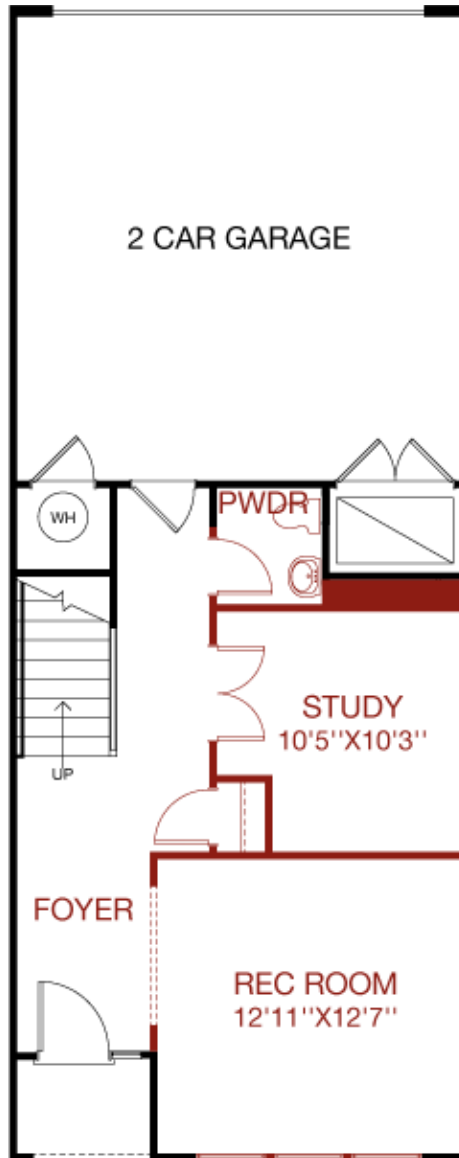

## Floorplan

### Lower Level



**Matthew Wilson**

 (301) 329-4301

 [mwilson@midatlanticbuilders.com](mailto:mwilson@midatlanticbuilders.com)



**Leif Wazen**

 (301) 329-4301

 [lwazen@midatlanticbuilders.com](mailto:lwazen@midatlanticbuilders.com)

Programs and incentives subject to change without notice and available only when lender and title company from builders approved list are used. Maximum promotional package value varies by community and houseplan. Builder assistance is not to exceed maximum promotional package value. Not all buyers may qualify for program savings. Qualification to be determined by Mid-Atlantic Builders' preferred lender(s) prior to contract ratification. See a Mid-Atlantic Builders Sales Counselor for specific promotional package details as some restrictions apply. The name Mid-Atlantic Builders and the Mid-Atlantic Builders logo are registered service marks of Mid-Atlantic Builders, Inc. | MHBR #8984



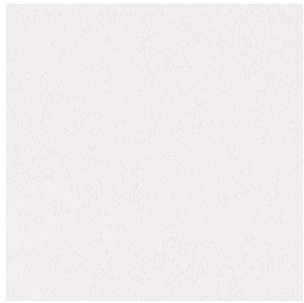

Upgraded  
Stainless Steel



Owner's Bath



Secondary Baths



Laundry Room



Carpet

\*Reminder: Variations in color are due to differences in computer monitors, video graphics cards, printers, and on-screen settings.\*