



Chelsea | \$683,140

5112 CURIE DRIVE, Bowie, MD 20716 | Homesite 19C
2,896 Sq. Ft. | 4 Beds | 3.5 Baths | Availability: 04/2024



- 24' Wide Townhome with 2-Car Rear Garage
- Entry Level Rec Room and Multi-Gen Bedroom Suite with Full Bath
- Open-Concept Kitchen Level with Family Room/Dining Area and Upgraded Kitchen Island Extension
- Upgraded Sliding Glass Doors off Family Room Leading to Rear Covered Terrace
- Luxurious Primary Suite with Upgraded Grand Shower
- Two Secondary Bedrooms with Walk-In-Closets and Walk-In Laundry Room



Eric Lyman

 (301) 329-4301

 elyman@MidAtlanticBuilders.com

Programs and incentives subject to change without notice and available only when lender and title company from builders approved list are used. Maximum promotional package value varies by community and houseplan. Builder assistance is not to exceed maximum promotional package value. Not all buyers may qualify for program savings. Qualification to be determined by Mid-Atlantic Builders' preferred lender(s) prior to contract ratification. See a Mid-Atlantic Builders Sales Counselor for specific promotional package details as some restrictions apply. The name Mid-Atlantic Builders and the Mid-Atlantic Builders logo are registered service marks of Mid-Atlantic Builders, Inc. | MHBR #8984



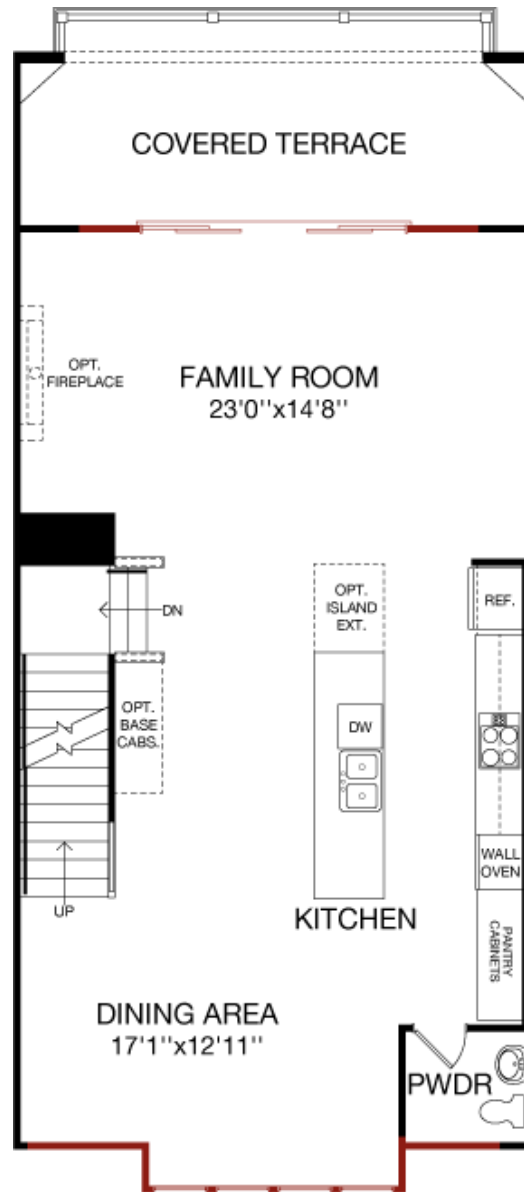

Floorplan

First Floor



Eric Lyman

 (301) 329-4301

 elyman@MidAtlanticBuilders.com

Programs and incentives subject to change without notice and available only when lender and title company from builders approved list are used. Maximum promotional package value varies by community and houseplan. Builder assistance is not to exceed maximum promotional package value. Not all buyers may qualify for program savings. Qualification to be determined by Mid-Atlantic Builders' preferred lender(s) prior to contract ratification. See a Mid-Atlantic Builders Sales Counselor for specific promotional package details as some restrictions apply. The name Mid-Atlantic Builders and the Mid-Atlantic Builders logo are registered service marks of Mid-Atlantic Builders, Inc. | MHBR #8984



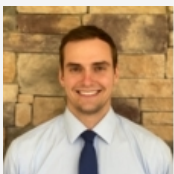
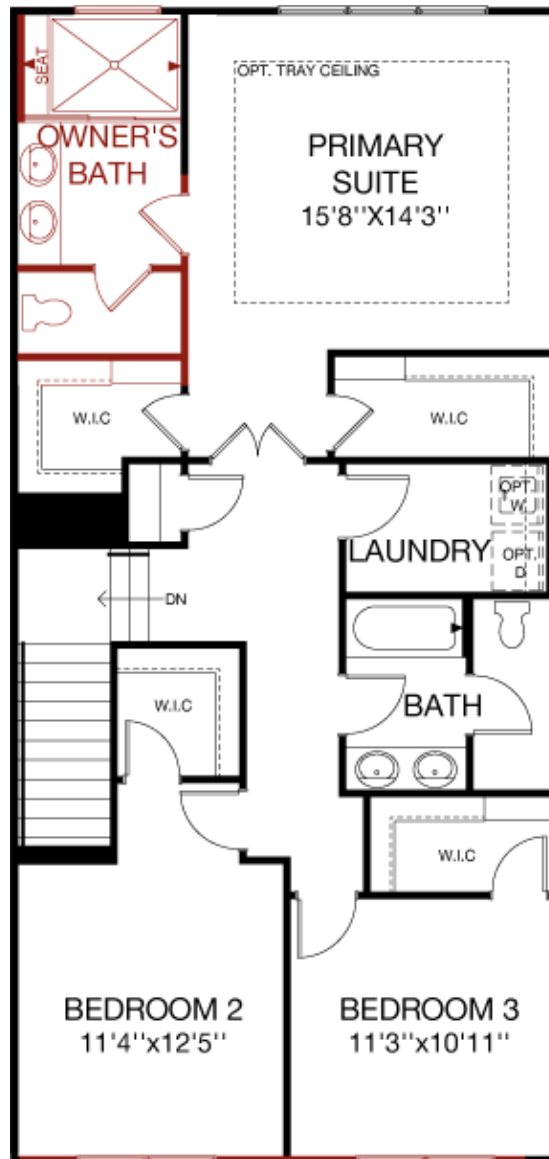

Floorplan

Second Floor



Eric Lyman

 (301) 329-4301

 elyman@MidAtlanticBuilders.com

Programs and incentives subject to change without notice and available only when lender and title company from builders approved list are used. Maximum promotional package value varies by community and houseplan. Builder assistance is not to exceed maximum promotional package value. Not all buyers may qualify for program savings. Qualification to be determined by Mid-Atlantic Builders' preferred lender(s) prior to contract ratification. See a Mid-Atlantic Builders Sales Counselor for specific promotional package details as some restrictions apply. The name Mid-Atlantic Builders and the Mid-Atlantic Builders logo are registered service marks of Mid-Atlantic Builders, Inc. | MHBR #8984



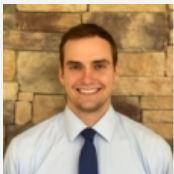
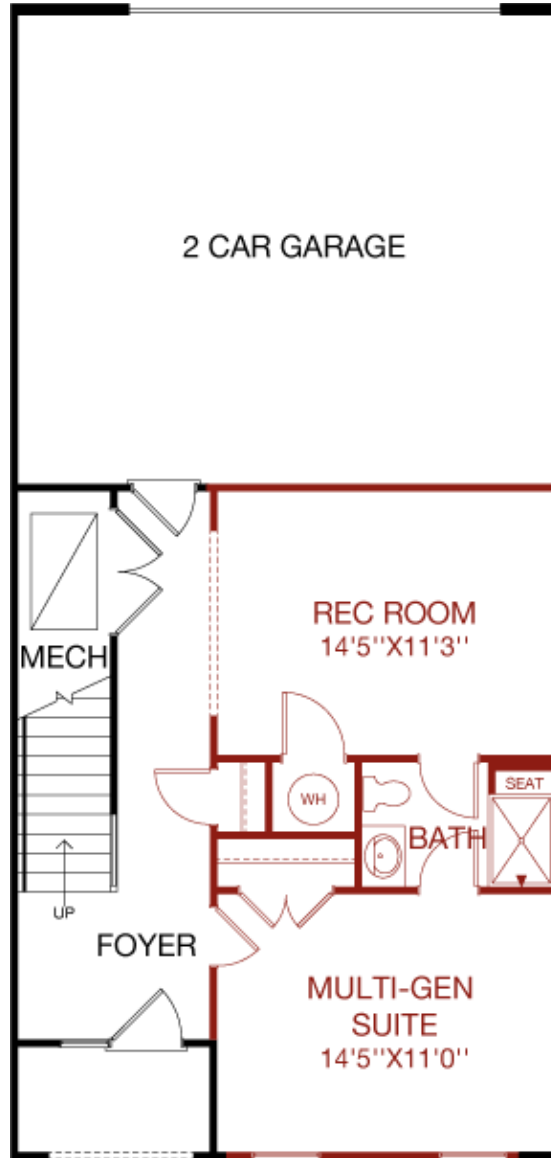

Floorplan

Lower Level



Eric Lyman

 (301) 329-4301

 elyman@MidAtlanticBuilders.com

Programs and incentives subject to change without notice and available only when lender and title company from builders approved list are used. Maximum promotional package value varies by community and houseplan. Builder assistance is not to exceed maximum promotional package value. Not all buyers may qualify for program savings. Qualification to be determined by Mid-Atlantic Builders' preferred lender(s) prior to contract ratification. See a Mid-Atlantic Builders Sales Counselor for specific promotional package details as some restrictions apply. The name Mid-Atlantic Builders and the Mid-Atlantic Builders logo are registered service marks of Mid-Atlantic Builders, Inc. | MHBR #8984





Owner's Bath



Secondary Baths

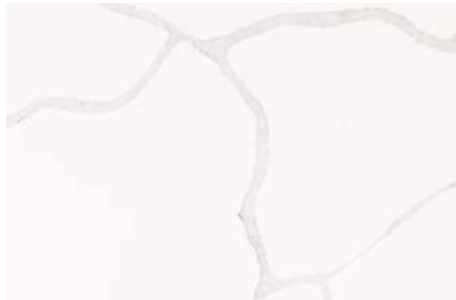

Laundry Room



Carpet

Reminder: Variations in color are due to differences in computer monitors, video graphics cards, printers, and on-screen settings.